

On the plant premises it is forbidden to:



Move through the plant premises at speeds greater than 10 km/h



Bring in and consuming alcohol and other intoxicants



Take pictures without the consent of Modular System



Smoke tobacco and tobacco products



Enter into restricted areas without authorization



Avoid contact with hazardous substances



In the event of an accident, there is a risk of release of gases, vapours, and liquids into the environment



Follow the instructions of the person in charge

OHS and health protection

Persons on the plant premises are required to:

- Abide by health and safety regulations and principles
- Abide by traffic regulations
- Park cars only in the designated areas
- Report any accidents and threats noticed
- Inside the halls to move only on designated routes, paying attention to any means of transport
- Comply with all warning signs and information boards
- Use personal protective equipment and protective clothing where required



Further:

- Visitors to the facility are required to move around the premises with a guide
- The segregation of all waste according to the description on the containers is obligatory on the plant premises
- In the event of unintentional pollution of the environment [leakage, spillage], the fact must be reported to security and, in the case of guests, to the caretaker.
- Hand disinfection, proper wearing of masks and keeping a distance is mandatory on the premises

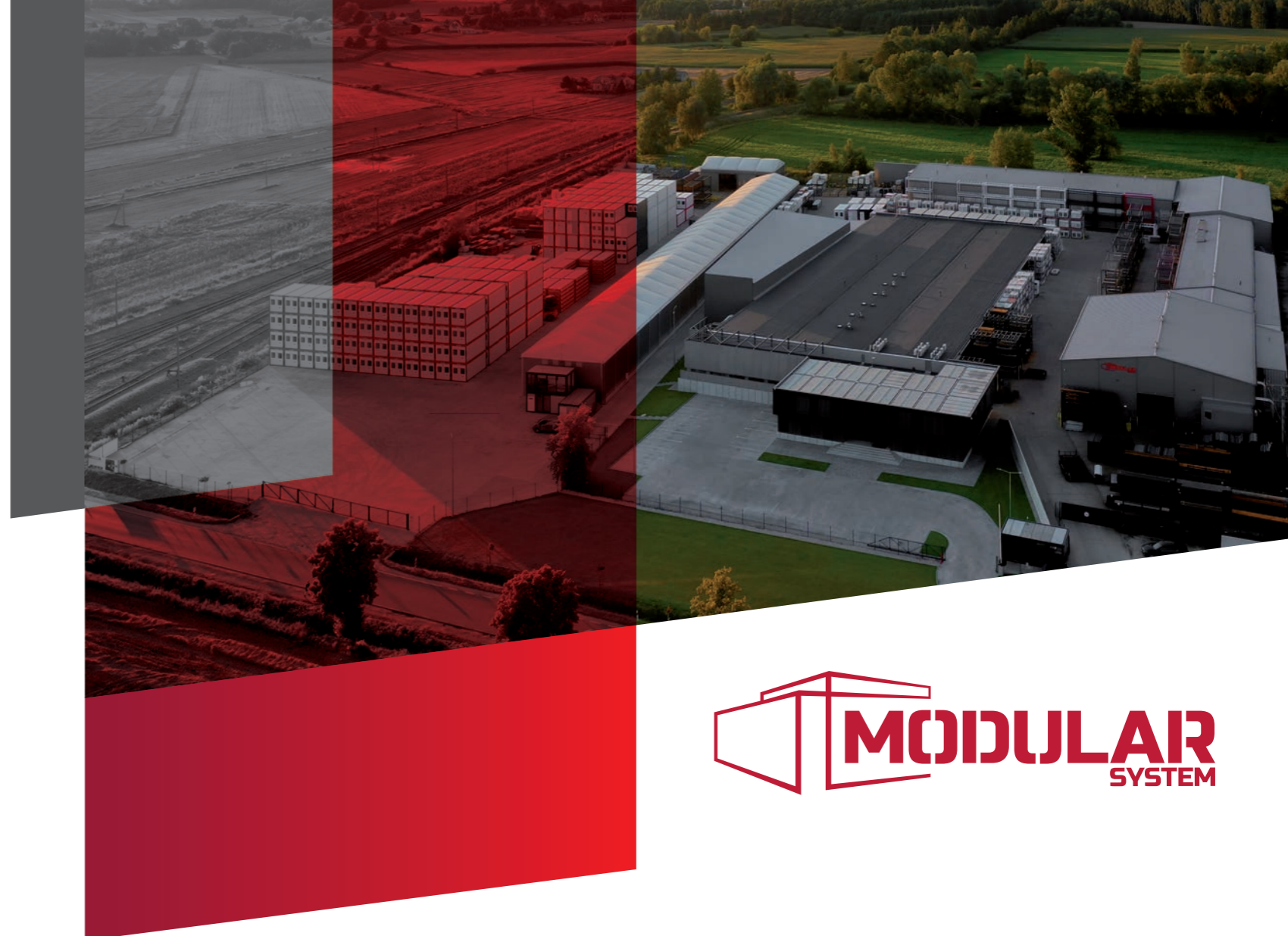

INFORMATION ON SAFETY ON THE AREA OF MODULAR SYSTEM

Welcome to Modular System
During your visit, we require compliance with our safety regulations designed to protect the health and life of visitors

In this folder you will find information on:

- Key rules on the plant premises
- Occupational health and safety at work and health protection
- Personal protective equipment
- What to do in the event of an emergency

When visiting the site, both visitors and employees of external companies must be protected against accidents and risks to life and health.
This requires absolute compliance with our safety regulations

Issue:

Date of Issue:

Emergency telephone

Fire brigade	998
Ambulance service	999
General emergency number	112
OHS service	539 772 120
Production Director	728 211 617
Maintenance Manager	538 961 122
Security guard station	538 637 014

SITE LAYOUT PLAN

Hazards present at the site:

- Follow the instructions of the person Transport hazards (forklifts, motor vehicles)
- Transport hazards (conveyors)
- Explosion hazard zone
- Use of flammable or explosive materials
- Electric shock
- UV radiation
- Burns (hot objects)
- High noise level
- Hazardous, toxic substances (poisonous, irritant and allergen chemicals)
- Risk of being dragged, of crushing, cutting off
- Risk of crushing from falling loads
- Risk of falling down
- Work at height
- Tripping hazard
- GAS CYLINDER Do not approach with open flame
- Warning of sharp components
- Rotating components
- High pressure

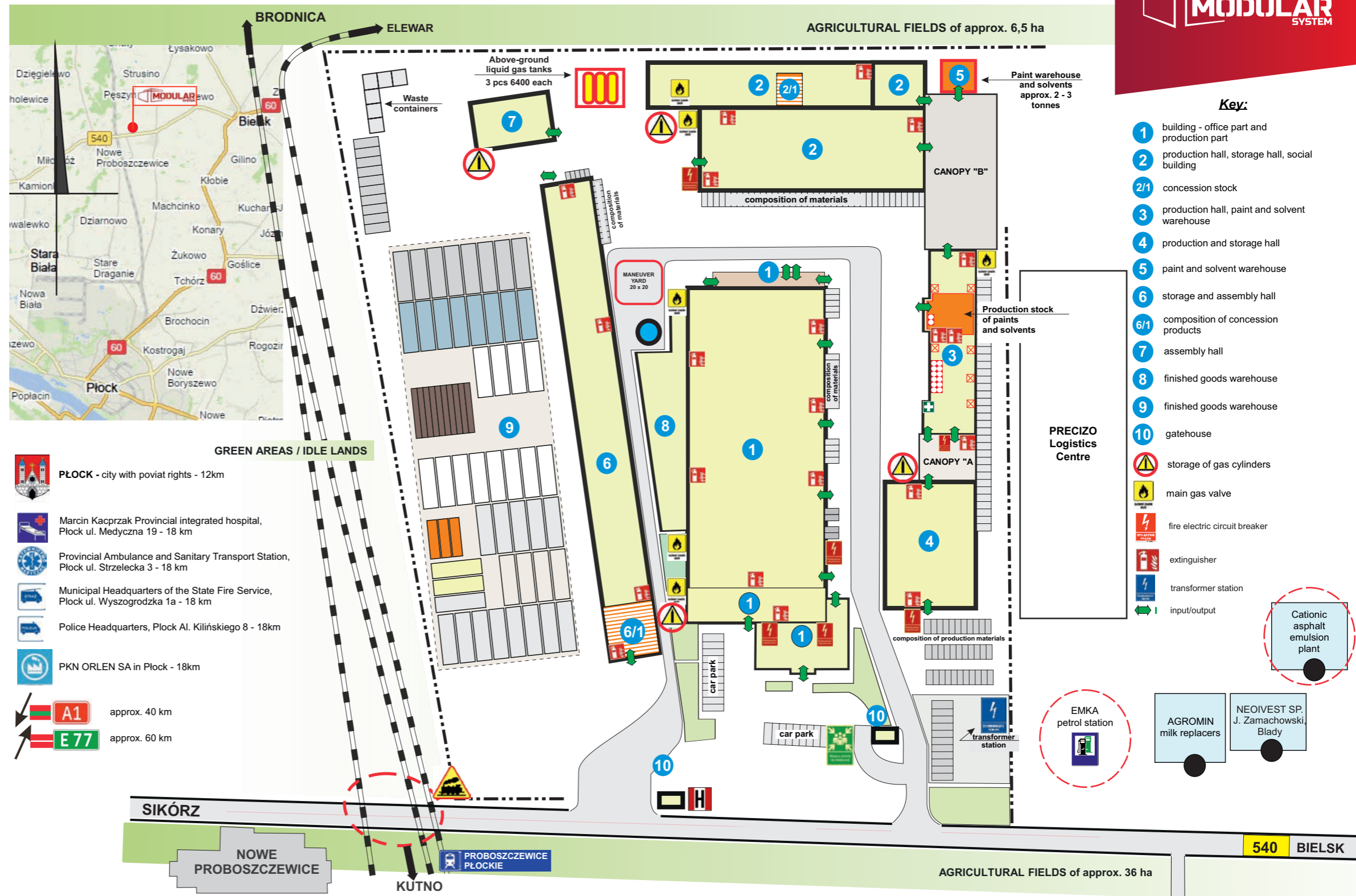

Emergency procedures

Evacuation safety rules:

- In the event that a hazard is identified, follow the procedures required in the plant
- Follow the instructions of persons in charge of the evacuation. Keep calm.
- When evacuating, move to the evacuation assembly point.
- Stay there and await further guidance

